

# SOLID FRONT PROCESS PRESSURE GAUGE (4 1/2")

## THERMOPLASTIC CASE



IPS-PG-14

### SPECIAL FEATURES

- SOLID FRONT THERMOPLASTIC CASE
- ACCURACY  $\pm 0.5\%$  F. S.
- EXCELLENT LOAD CYCLE STABILITY & SHOCK RESISTANT
- WETTED PARTS AISI 316L
- STANDARD FOLLOWED ANSI/ASME - B 40.100

### APPLICATIONS

- SUITABLE FOR CHEMICAL / PETROCHEMICAL, POWER STATIONS, MINING, ON AND OFFSHORE, MECHANICAL ENGINEERING AND PLANT ENGINEERING.
- SUITABLE FOR CORROSIVE ENVIRONMENT AND GASEOUS OR LIQUID MEDIA THAT WILL NOT OBSTRUCT THE PRESSURE SYSTEM.
- WITH LIQUID FILLED CASE WITH HIGH DYNAMIC PRESSURE PULSATIONS OR VIBRATIONS.

### SPECIFICATIONS

#### STANDARD VERSION : (4 1/2")

Accuracy	: $\pm 0.5\%$ F. S. (As per ANSI B40.100)
Ambient temperature	: - 20°C to + 65°C
Process temperature	: Max 200°C
Operating pressure range	: 75 % of Scale Value
Over pressure limit	: $\leq 100$ bar : 125% of Max. Scale Value : $> 100$ to $\leq 600$ bar : 115% of Max. Scale Value : $> 600$ to $\leq 1600$ bar : 110% of Max. Scale Value

Case	: Black Glass Reinforced Thermoplastic (PBTP)
Bourdon	: AISI 316L SS
Socket	: AISI 316L SS
Movement	: AISI 304 SS
Joints	: Tig Argon Arc Welding

Protection	: IP 65
Dial	: Aluminum, black graduation on white background
Pointer	: Aluminum, black Coloured, Micrometer Zero Adjustable
Window	: Shatterproof / Safety Glass
Gasket	: Neoprene

#### GLYCERINE FILLED VERSION (OPTION PY)

Accuracy	: $\pm 1.0\%$ of F. S.
Ambient Temperature	: Maximum 65°C
Process Temperature	: Maximum 65°C
Window	: Plexi Glass
Dampening Liquids	: Glycerine 99.7%
Other Features	: Refer Specification of Standard Version

#### Temperature effect:

The variation of indication caused by effects of temperature is to be calculated by below formula; which is to be added in the specified accuracy while measurement :-

Formula :  $\pm 0.04 \times (t_2 - t_1) \%$  of F. S.

where  $t_1$  = reference temperature (+20°C) and  $t_2$  = ambient temperature in °C.



**Industrix Precise Solutions Private Limited**

Room No – 303, Bhumika Residency, Plot No-21, Sector-20, Roadpali, Kalamboli, Panvel (Tal.), Raigad (Dist.), Maharashtra, India – 410218.

Mobile: +91 99309 98399 / +91 99674 97447

E-mail: [admin@ipspl.in](mailto:admin@ipspl.in) / [sales@ipspl.in](mailto:sales@ipspl.in) Website: [www.ipspl.in](http://www.ipspl.in)

CIN : U52399MH2021PTC368555

# SOLID FRONT PROCESS PRESSURE GAUGE (4 1/2")

## DIMENSIONS - STANDARD VERSION



IPS-PG-14

TYPE 1

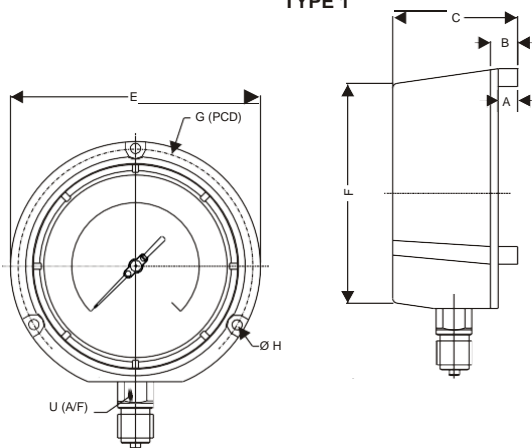

NS	A	B	C	E	F	G	H	U	Weight in gram (with BOX)	Weight in gram (With Glycerin & Box)
4 1/2"	13	25	84	148	129	137	6	22	950.00	1250.00

TYPE 3

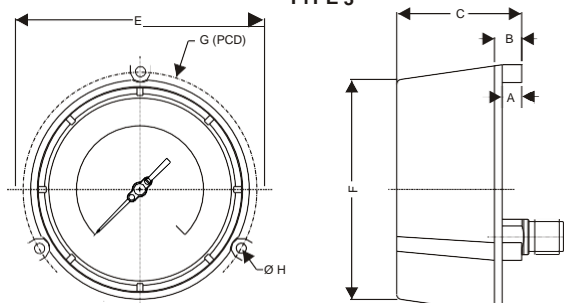

NS	A	B	C	E	F	G	H	U	Weight in gram (with BOX)
4 1/2"	13	25	84	148	129	137	6	22	925.00

TYPE 5

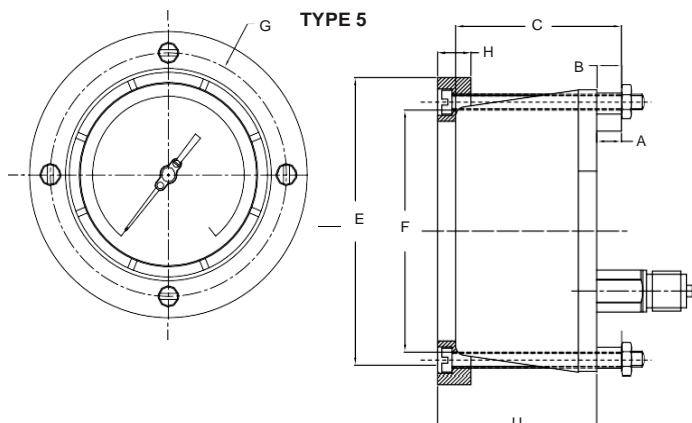

NS	A	B	C	E	F	G	H	U	Weight in gram (with BOX)
4 1/2"	13	25	84	148	129	137	12.5	74	1150.00

- Notes :
- Drawings are not to scale.
  - NS = Nominal Size
  - All Dimensions are in mm.
  - H - Arrangement for Mounting type 1
  - Weights mentioned are approximate and for standard product. Weight can be different after selection of options.

### RANGE TABLE

Following are the example tables for kg/cm<sup>2</sup> & psi scales

### PRESSURE RANGE

SINGLE SCALE (kg/cm² or bar)					
0/0.6	0/4	0/25	0/160	0/1000	
0/1	0/6	0/40	0/250	0/1600	
0/1.6	0/10	0/60	0/400	0/2100	
0/2.5	0/16	0/100	0/600		
DUAL SCALE (kg/cm² with psi)					
psi      kg/cm²		psi      kg/cm²		psi      kg/cm²	
0/15	0/1	0/400	0/28	0/4000	0/280
0/30	0/2	0/500	0/35	0/5000	0/350
0/60	0/4	0/600	0/40	0/6000	0/400
0/100	0/7	0/1000	0/70	0/10000	0/700
0/150	0/10	0/1500	0/100	0/15000	0/1000
0/220	0/16	0/2200	0/160	0/22000	0/1600
0/300	0/20	0/3000	0/200	0/30000	0/2000



**Industrix Precise Solutions Private Limited**

Room No – 303, Bhumika Residency, Plot No-21, Sector-20, Roadpali, Kalamboli, Panvel (Tal.), Raigad (Dist.), Maharashtra, India – 410218.

Mobile: +91 99309 98399 / +91 99674 97447

E-mail: [admin@ipspl.in](mailto:admin@ipspl.in) / [sales@ipspl.in](mailto:sales@ipspl.in) Website: [www.ipspl.in](http://www.ipspl.in)

CIN : U52399MH2021PTC368555

# SOLID FRONT PROCESS PRESSURE GAUGE (4 1/2")



IPS-PG-14

## VACUUM & COMPOUND RANGE

DUAL SCALE					
inHg with psi	mmHg with kg/cm <sup>2</sup>	inHg with psi	mmHg with kg/cm <sup>2</sup>	inHg with psi	mmHg with kg/cm <sup>2</sup>
- 30/0	- 760 / 0	- 30/60	- 760 / 3	- 30/200	- 760 / 15
- 30/15	- 760 / 1	- 30/100	- 760 / 6	- 30/300	- 760 / 20
- 30/30	- 760 / 2	- 30/150	- 760 / 9	- 30/350	- 760 / 24
SINGLE SCALE (kg/cm <sup>2</sup> )					
- 1/0	- 1/1.5	- 1/5	- 1/15		
- 1/0.6	- 1/3	- 1/9	- 1/24		

## ACCESSORIES (Refer Datasheet for complete specifications)

<b>EB</b>	COOLING TOWER	<b>*</b>	NEEDLE VALVE
<b>EC</b>	GAUGE COCK	<b>EG</b>	SNUBBER
<b>ED</b>	OVER LOAD PROTECTOR (GAUGE SAVER)**	<b>EH</b>	SIPHON

\* Refer catalogue for Valves & Manifolds.

\*\* For Pressure Ranges.

## HOW TO ORDER

### BASIC MODEL

### CODE

### NOMINAL SIZE

G

4 1/2"

### TYPE OF MOUNTING

- 1 WALL / SURFACE / PROJECTION MOUNTING WITH BOTTOM ENTRY
- 3 DIRECT LOWER BACK ENTRY (NEVER FILLABLE)
- 5 LOWER BACK ENTRY WITH FRONT FLANGE

### GAUGE CONNECTION

<b>3BM</b>	3/8" BSP (M)	<b>2NM</b>	1/4" NPT (M) STANDARD
<b>4BM</b>	1/2" BSP (M) STANDARD	<b>4NM</b>	1/2" NPT (M) STANDARD

Note : Connections like Metric/ PT/ PF/ Flaired/ UNF/ G/ R etc can be provided on request.

### RANGE

### REFER RANGE TABLE

#### OPTIONAL EXTRAS

<b>OB</b>	ACCURACY 1.0% OF F.S.	<b>RX</b>	SHATTERPROOF / SAFETY GLASS
<b>TI</b>	MONEL BOURDON & SOCKET (MONEL VERSION)**	<b>TF</b>	CONFORMITY AS PER NACE MR 0175 FS
<b>PW</b>	FIVE POINT CALIBRATION CERTIFICATE		FILLABLE LIQUID SILICON OIL* <b>FG</b>
<b>PU</b>	CALIBRATION CERTIFICATE TRACEABLE TO NATIONAL/INTERNATIONAL STANDARDS		FILLABLE LIQUID GLYCERINE
<b>RH</b>	CUSTOM DESIGNED DIAL	<b>SF</b>	MOVEMENT WITH DAMPENING JELLY
<b>SG</b>	OXYGEN SERVICE (FOR DRY VERSION)	<b>QB</b>	INTEGRAL DAMPENING SCREW (AISI 316 SS)
<b>SW</b>	DIAL TAG MARKING	<b>FL</b>	INTEGRAL DAMPENING SCREW (MONEL)**
<b>SX</b>	SS TAG PLATE	<b>PZ</b>	DAMPENING LIQUID MINERAL LIQUID FILLED <b>PX</b>
<b>TB</b>	HELIUM LEAK TEST		DAMPENING LIQUID FLOUROLUBE FILLED <b>PY</b>
<b>RR</b>	ENCLOSURE PROTECTION IP 66		DAMPENING LIQUID GLYCERINE FILLED
<b>ST</b>	FIBRE GLASS REINFORCED POLYPROPYLENE BOD	<b>QA</b>	DAMPENING LIQUID SILICON OIL FILLED*
<b>SD</b>	AISI 316 SS MOVEMENT	<b>ZL</b>	OVER RANGE PROTECTION 150% OF F. S.
		<b>GH</b>	MATERIAL TEST CERTIFICATES***

\* Gasket & Filling plug of NBR. Refer Price List for Viton.

\*\* INTEGRAL DAMPENING SCREW WILL BE IN MONEL IF ORDERED. REFER OPTION FL

\*\*\* MATERIAL TEST CERTIFICATES WILL BE PROVIDED FOR WETTED PARTS ONLY WITH CHEMICAL COMPOSITION TESTING. FOR OTHERS, PLEASE CONSULT FACTORY.

IPS-PG-14

X

X

XXX

0-10  
kg/cm<sup>2</sup>

XX



# Industrix Precise Solutions Private Limited

Room No – 303, Bhumika Residency, Plot No-21, Sector-20, Roadpali, Kalamboli, Panvel (Tal.), Raigad (Dist.), Maharashtra, India – 410218.

Mobile: +91 99309 98399 / +91 99674 97447

E-mail: [admin@ipspl.in](mailto:admin@ipspl.in) / [sales@ipspl.in](mailto:sales@ipspl.in) Website: [www.ipspl.in](http://www.ipspl.in)

CIN : U52399MH2021PTC368555